

# ST AUGUSTINE'S SURGERY



## GT55 NI Commercial Door

One of the most secure swing doors available on the market today, the GT55 NI has been specifically designed for high traffic environments where no insulation is required. This makes it a very robust and highly cost-effective choice when specifying applications such as shopping complexes and retail centres that require significant partitioning without the need for thermal insulation.

The GT55 NI can be easily integrated with our ground floor treatment system and is available in single colour options, with a choice of polyester powder coating and anodised finishes. A full range of security and customisable hardware is also available to suit the specific demands of your design.



### DESIGN FEATURES

- › Pocket and bead glazed for ease of site glazing
- › Slim 55mm frame profile for increased glass appearance
- › Ladder frame construction to enable easy on-site installation
- › Fully compatible with other AluK systems
- › Mullion drainage

### OPTIONS

- › Can accommodate 6mm–28mm sealed units for acoustic performance
- › Wide range of hardware available offering full customisation
- › Available in single colour polyester powder coating, texture and anodised finishes
- › Internal and external screen application available

Secured by Design



Police Preferred Specification



## SPECIFICATIONS

Performance and accreditations	Single	Double	GT55 NI Screening
U-Value (Double Glazing) (Ug: 1.0 W/m²K)	3.6 W/m²K	3.0 W/m²K	2.0 W/m²K
Air Permeability	-	-	Class 4 (600 Pa)
Water Tightness	-	-	Class 8A (450 Pa)
Wind Resistance	-	-	Class 5 (2000 Pa)
Durability EN 1191 Category	50,000 Cycles	50,000 Cycles	-
Security	PAS 24 & SBD	PAS 24 & SBD	PAS 24 & SBD
<b>System</b>			
Depth	110mm	110mm	110mm
<b>Size and weight limits</b>			
Maximum Door Leaf Size (mm)	1250w x 2400h	2500w x 2400h	-
Maximum Door Leaf Weight	80kg	80kg	-
<b>Glazing</b>			
Glazing Thickness (Single Glazing)	6mm - 12mm	6mm - 12mm	6mm - 12mm
Glazing Thickness (Double Glazing)	24mm - 28mm	24mm - 28mm	24mm - 28mm
<b>System Features</b>			
Single Colour	✓	✓	✓
Dual Colour	x	x	x
Textured Finish	✓	✓	✓
Anodised Finish	✓	✓	✓
Fire Exit option	✓	✓	✓
Part M compliant low threshold	✓	✓	-
Anti-Finger Trap	✓	✓	-
Sightlines	144mm	176mm	55mm
Mid-Rail and Lay Bar	✓	✓	✓
Panel Door	✓	✓	-
Single Point Locking	✓	✓	-
Concealed Hinges	✓	✓	-
Barrel Hinges	-	-	-
Electro Mechanical Locking	✓	✓	-
Automatic Door	✓	✓	-

## SBD CONFIGURATIONS



## CAD CROSS SECTIONS

Additional details are available on request.

### GT55 NI JAMB LOCKING STILE

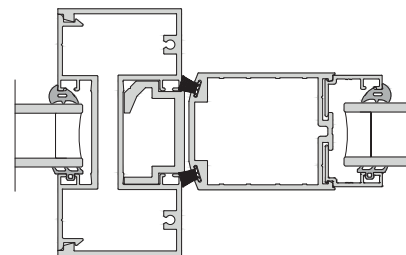

### GT55 NI MEETING STILE



### GT55 NI SCREEN CILL

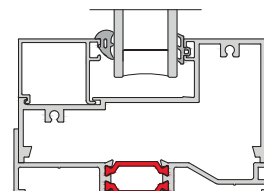

### GT55 NI SCREEN MULLION

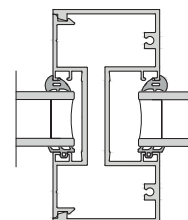

### GT55 NI JAMB ANTI FINGER TRAP

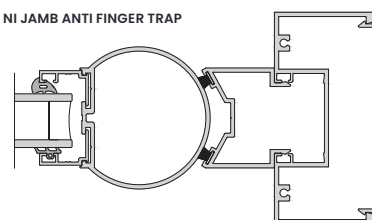

### GT55 NI LOW THRESHOLD

